

TECHNICAL BULLETIN



FUJI HEAVY INDUSTRIES LTD.

JCAB APPROVED

HEAD OFFICE ; SUBARU BLDG.
SHINJUKU, TOKYO, JAPAN

NO. 200-022 DATE June 5, 1989 (SUPERSEDES NO.)
REV. DATE (SUPERSEDES NO.)
REASON

1. SUBJECT : Installation of Improved Brake Link Rod for Rudder Pedal Installation
2. AIRCRAFT AFFECTED : All FA-200 series aircraft S/N 12 through 297.
3. PRIORITY : Desirable.
4. REASON : To increase safety margine for possible wear in rudder pedal system.
5. DESCRIPTION : Installation of improved brake link rod.
6. ACCOMPLISHMENT : At customer's option.
7. APPROVAL : JCAB Approval (No-Tokyo-1-004) May 29, 1989
8. PARTS REQUIRED : The following parts are required to accomplish this-bulletin:

(1) 200-524074-21	ROD ASSY	1 EA
(2) 200-524079-21	ROD ASSY	1 EA
(3) MS24665-134	COTTER PIN	4 EA
9. SPECAIL TOOL : None required.
10. WEIGHT AND BALANCE: Not affected.
11. REFERENCE : Not applicable.
12. DETAILED INSTRUCTIONS:

See figure 1.

 - (1) Remove brake link rods P/N 200-524079-6 and 200-524075-5 (item A, figure 1) from each right pedal of left and right seats.
 - (2) Install new rods P/N 200-524079-21 (for right seat) and 200-524074-21 (for left seat).

Caution

New rods must be installed as a matched set. Installation of either rod only is not permissible.
New rod must be installed with "deeper slot in lower fork end" aft. This ensures adequate clearance between slotted rod end and mating part.

AIRCRAFT DIVISION

1-11 YOUNAN 1 CHOME. UTSUNOMIYA TOCHIGI JAPAN 〒320
TEL 0286 (59) 4833 TELEX 3522 176

TECHNICAL BULLETIN 200-022

PAGE 1 OF 3

- (3) After installation of new rods, accomplish inspection in accordance with Service Bulletin 200-002C.
- (4) Service brake cylinders in accordance with the applicable service manual.
- (5) Check brake and rudder for proper operation.
- (6) Secure rod attaching nut with cotter pin P/N MS24665-134 (4 places).
- (7) Return airplane to flight status.
- (8) After rods have been replaced, make entry in aircraft log book.

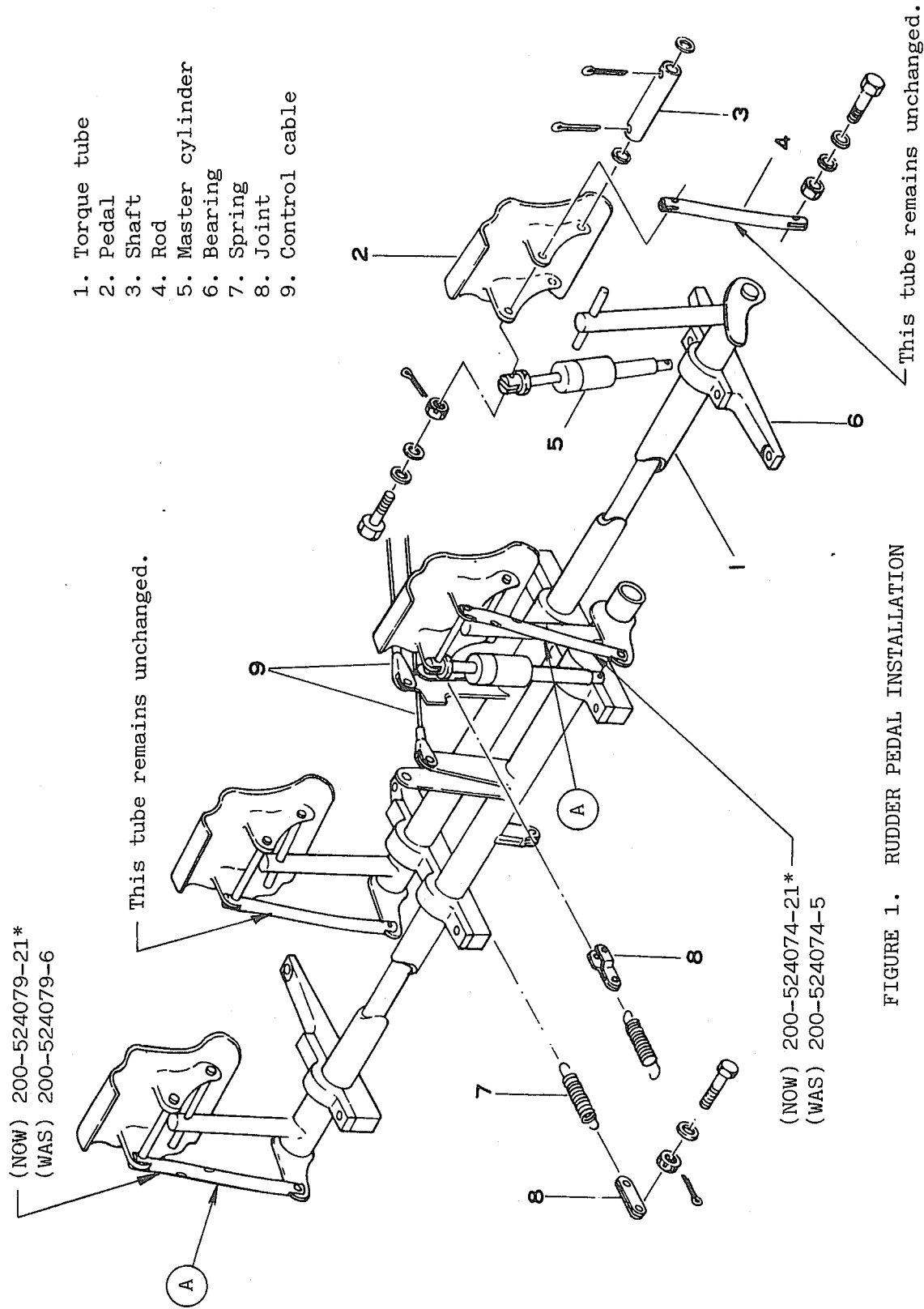

- 1. Torque tube
- 2. Pedal
- 3. Shaft
- 4. Rod
- 5. Master cylinder
- 6. Bearing
- 7. Spring
- 8. Joint
- 9. Control cable

FIGURE 1. RUDDER PEDAL INSTALLATION

*New tube is 5 mm longer than the existing tube.